

These drawings relate only to Glass Vice® Clearline and its fixings. All other elements are shown indicative only.

© 2024. The copyright of this document is the property of Glass Vice Limited and shall not be reproduced, copied, loaned or disposed of directly, or indirectly, nor used for any purpose other than that for which it is specifically furnished without prior consent.



Glass Vice JV88 Internal Wall Frame

JV88 Base Fixing

Section and Elevation

Date: Sep 2025
Scale: 1 : 10

Quick Code:

gv_wall_jv88.rvt
All dimensions in millimetres
www.glassvice.com
Phone +64 9 414 6565
info@glassvice.com

GV_JVWL_1010

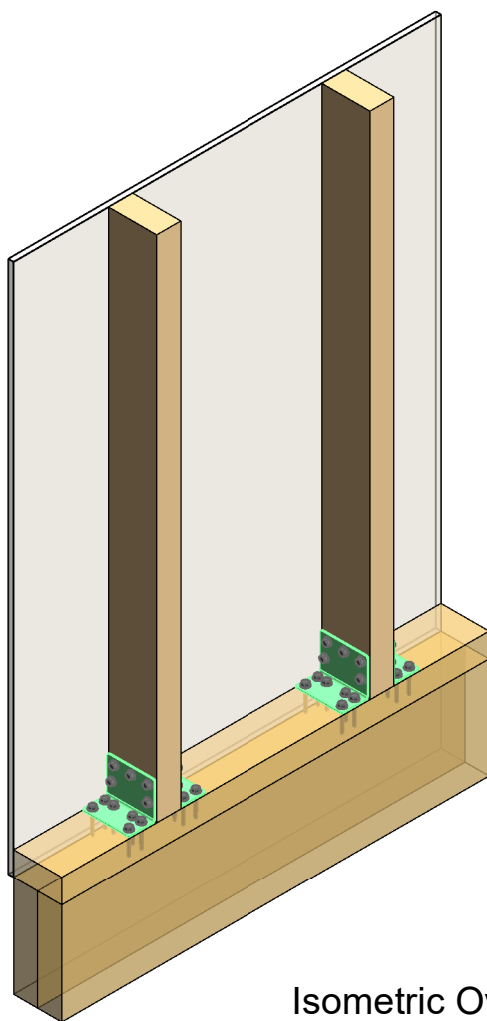

Isometric Overview

Pair of JV88 SS angle brackets per stud. 5/14g x 25mm SS Hex Tek Screws per side into single stud and 6/14g x 88mm SS Hex Tek Screws per side into wall plate

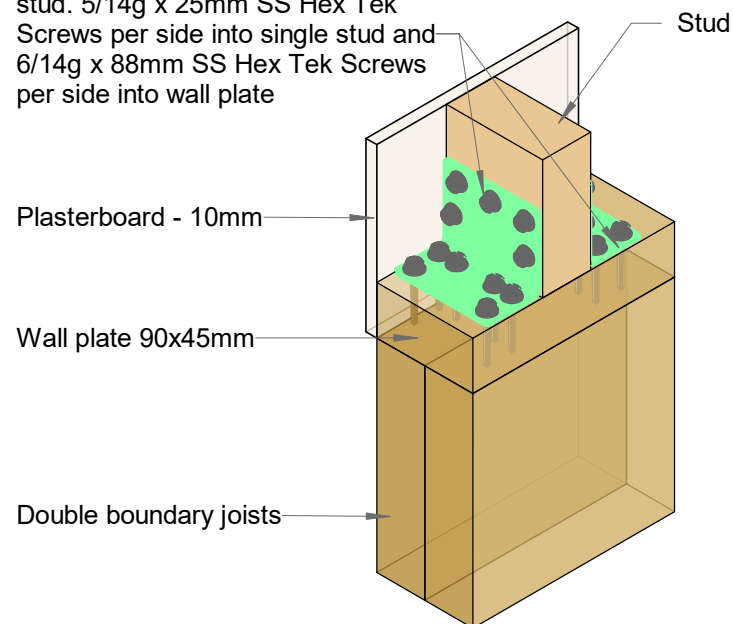

Isometric Detail

These drawings relate only to Glass Vice® Clearline and its fixings. All other elements are shown indicative only.

© 2024. The copyright of this document is the property of Glass Vice Limited and shall not be reproduced, copied, loaned or disposed of directly, or indirectly, nor used for any purpose other than that for which it is specifically furnished without prior consent.



Glass Vice JV88 Internal Wall Frame

JV88 Base Fixing

Isometric Views

Date: Sep 2025
Scale:

Quick Code:

gv_wall_jv88.rvt
All dimensions in millimetres
www.glassvice.com
Phone +64 9 414 6565
info@glassvice.com

GV_JVWL_1020